

Technical Data Sheet

CODE 16137

CA 315 MD E W

Centrifugal duct fans for wall mounting



Certifications



IMQ Performance



TECHNICAL AND PERFORMANCE DATA

Absorbed power 1st speed (W)	48	Delivery 1st speed (l/s)	136.1
Frequency (Hz)	50-60	Delivery 1st speed (m ³ /h)	490
Insulation Class	II°	Max delivery at max speed (l/s)	286.1
IP	44	Max delivery at max speed (m ³ /h)	1030
Max absorbed Power at 60Hz (W)	175	Pressure - 1st speed (mmH2O)	35.7
Max ambient temperature for continuous operation (°C)	50	Pressure - 1st speed (Pa)	350.5
Max. absorbed Current at max. speed (A)	0,55	Pressure max - max speed (mmH2O)	58.2
Max. absorbed Current at min. speed (A)	0.48	Pressure max - max speed (Pa)	570.8
Max. absorbed power at max speed (W)	120	RPM max	2670
Nominal Diameter (mm)	315	RPM min	1335
Voltage (V)	220-240	Sound pressure level Lp [dB (A)] 3m - max speed	51.4
Weight (Kg)	9,4	Sound pressure level Lp [dB (A)] 3m - min speed	41.2

DIMENSIONS

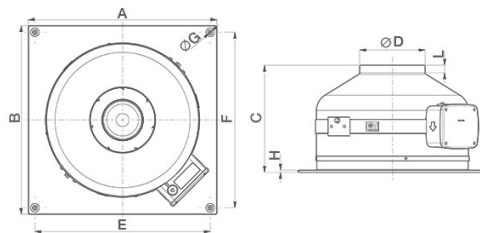

Size A (mm)	489
Size B (mm)	489
Size C (mm)	260
Size D (mm)	∅ 312
Size E (mm)	459
Size F (mm)	459
Size G (mm)	∅ 5
Size H (mm)	5
Size L (mm)	36
Size M (mm)	252

PER INFORMAZIONI:

Servizio al Cliente: tel +39 02 90699395 premendo 1 dopo messaggio registrato (consulenza su prodotti e impianti)

Pre & Post Vendita: fax +39 02 90699302

Email prevendita: prevendita@vortice-italy.com

Technical Data Sheet

CODE 16137

CA 315 MD E W

Centrifugal duct fans for wall mounting



DESCRIPTION

- Pickled and phosphated steel housing/roof mounting plate with polyester powder-coated finish, resistant to the aggressive action of atmospheric agents.
- Nominal diameter 315 mm.
- 3 speed fan through TRIO-CA optional control (cod. 12869), consisting of:
 - External rotor AC motor with thermal overload cutout and shaft turning in ball bearings,
 - backward curved impeller.
- Operation controllable by remote sensors monitoring: Temperature, Relative Humidity, Smoke and Presence.
- Zinc-coated steel brackets for wall mounting.

CURVES

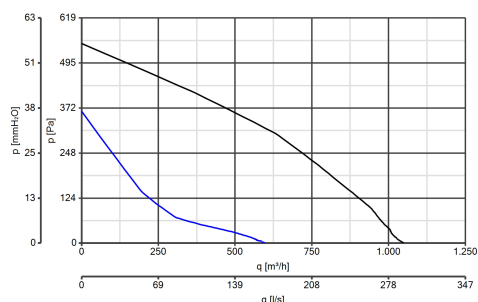
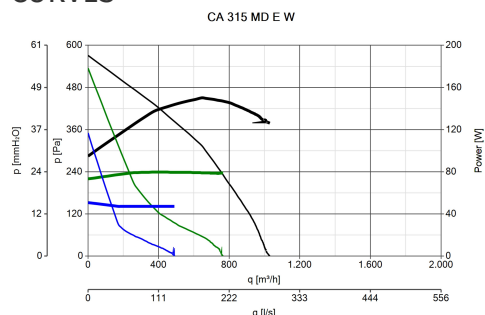

ACCESSORIES



C TEMP

Code 12992

C SMOKE

Code 12993

C HCS

Code 12994

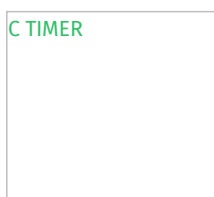

C PIR

Code 12998

C TIMER

Code 12999

KIT SCB (TRASF.E.C.)

Code 22481

CA-G 315 (GRIGLIA DI PROTEZIONE)

Code 22775



PER INFORMAZIONI:

Servizio al Cliente: tel +39 02 90699395 premendo 1 dopo messaggio registrato (consulenza su prodotti e impianti)

Pre & Post Vendita: fax +39 02 90699302

Email prevendita: prevendita@vortice-italy.com

**(PERSIANA
GRAVITA')**

Code 50550

**(TELAIO CON
RETE ANTINF.)**

Code 51150

**(COMANDO EL.
1.5 A)**

Code 12966

**(COMANDO EL.
2.5 A)**

Code 12967



TRIO-CA

Code 12869