

Technical Data Sheet

CODE 42217

MPC-E 354 M

Medium-pressure long cased axial fans



Certifications

CE CE

EAC EAC

TECHNICAL AND PERFORMANCE DATA

Absorbed Current max (A)	0,70	Number of Poles	4
Absorbed Power max (W)	152	Voltage (V)	230
Frequency (Hz)	50	Weight (Kg)	13,4
Insulation Class	I°	Delivery max (l/s)	875
IP	X4	Delivery max (m³/h)	3150
Max ambient temperature for continuous operation (°C)	70	Pressure max (mmH2O)	17.2
Min ambient temperature for continuous operation (°C)	-25	Pressure max (Pa)	169
Nominal Diameter (mm)	350	RPM	1450
Number of Phases (Ph)	1	Sound power level Lw [dB(A)]	57.3
		Sound Pressure level Lp [dB (A)] 3m	36.8

DIMENSIONS

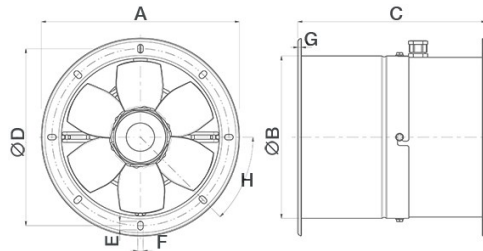

Size A (mm)	Ø 432
Size B (mm)	Ø 368
Size C (mm)	330
Size D (mm)	Ø 405
Size E (mm)	14
Size F (mm)	9
Size G (mm)	4
Size H (mm)	45°

PER INFORMAZIONI:

Servizio al Cliente: tel +39 02 90699395 premendo 1 dopo messaggio registrato (consulenza su prodotti e impianti)

Pre & Post Vendita: fax +39 02 90699302

Email prevendita: prevendita@vortice-italy.com

Technical Data Sheet

CODE 42217

MPC-E 354 M

Medium-pressure long cased axial fans



DESCRIPTION

- Nominal diameter 350 mm
- 2 rolled steel flange sections, welded, phosphated and polyester powder coated in practical grey colour with hammered effect finish, guaranteeing long-term resistance to atmospheric agents.
- 1 speed single phase AC motor with shaft turning in double shielded ball bearings, insulation class F.
- Maximum air flow: 3,500 m³/h.
- Impeller with 6 wing profile blades, dynamically balanced (UNI ISO 1940 – Balancing class 6.3), optimized to deliver maximum performance and low noise levels, moulded from filled polypropylene for superior dimensional stability and resistance to atmospheric agents, and keyed to a diecast aluminium hub.
- Vortice speed controller.

CURVES

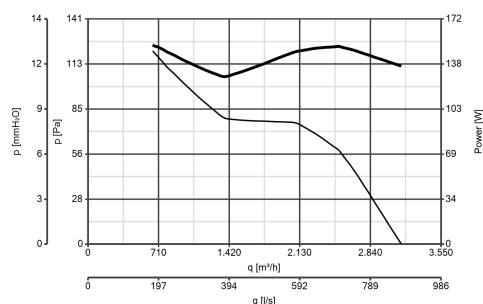

ACCESSORIES



IREM 3 CD
99250080

Code 12931

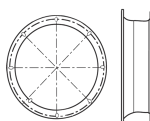

MPC BO 350
(BOCCAGLIO)

Code 22537

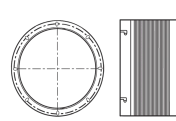

MPC RA 350
(RACCORDO FLESSIBILE)

Code 22518



MPC SU 350
(SUPPORTO)

Code 22533

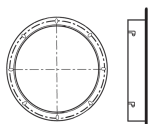

MPC FL 350
(FLANGIA)

Code 22525

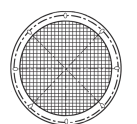

MPC RP 350
(RETE DI PROTEZIONE)

Code 22529



IRM 40

Code 12922

PER INFORMAZIONI:

Servizio al Cliente: tel +39 02 90699395 premendo 1 dopo messaggio registrato (consulenza su prodotti e impianti)

Pre & Post Vendita: fax +39 02 90699302

Email prevendita: prevendita@vortice-italy.com