

Technical Data Sheet

CODE 42228

MPC-E 404 M

Medium-pressure long cased axial fans



Certifications

CE CE

EAC EAC

TECHNICAL AND PERFORMANCE DATA

Absorbed Current max (A)	1,30	Number of Poles	4
Absorbed Power max (W)	272	Voltage (V)	230
Frequency (Hz)	50	Weight (Kg)	14,0
Insulation Class	I°	Delivery max (l/s)	1333
IP	X4	Delivery max (m³/h)	4800
Max ambient temperature for continuous operation (°C)	70	Pressure max (mmH2O)	18.7
Min ambient temperature for continuous operation (°C)	-25	Pressure max (Pa)	183
Nominal Diameter (mm)	400	RPM	1440
Number of Phases (Ph)	1	Sound power level Lw [dB(A)]	68.6
		Sound Pressure level Lp [dB (A)] 3m	48.1

DIMENSIONS

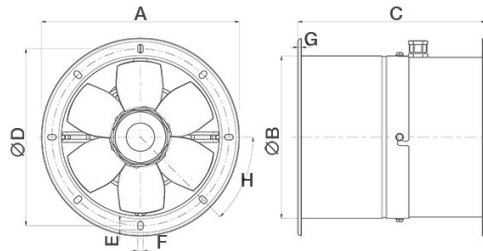

Size A (mm)	ø 475
Size B (mm)	ø 418
Size C (mm)	330
Size D (mm)	ø 448
Size E (mm)	14
Size F (mm)	9
Size G (mm)	4
Size H (mm)	45°

PER INFORMAZIONI:

Servizio al Cliente: tel +39 02 90699395 premendo 1 dopo messaggio registrato (consulenza su prodotti e impianti)

Pre & Post Vendita: fax +39 02 90699302

Email prevendita: prevendita@vortice-italy.com

Technical Data Sheet

CODE 42228

MPC-E 404 M

Medium-pressure long cased axial fans



DESCRIPTION

- Nominal diameter 400 mm
- 2 rolled steel flange sections, welded, phosphated and polyester powder coated in practical grey colour with hammered effect finish, guaranteeing long-term resistance to atmospheric agents.
- 1 speed single phase AC motor with shaft turning in double shielded ball bearings, insulation class F.
- Maximum air flow: 5.000 m³/h.
- Impeller with 6 wing profile blades, dynamically balanced (UNI ISO 1940 – Balancing class 6.3), optimized to deliver maximum performance and low noise levels, moulded from filled polypropylene for superior dimensional stability and resistance to atmospheric agents, and keyed to a diecast aluminium hub.
- Vortice speed controller.

CURVES

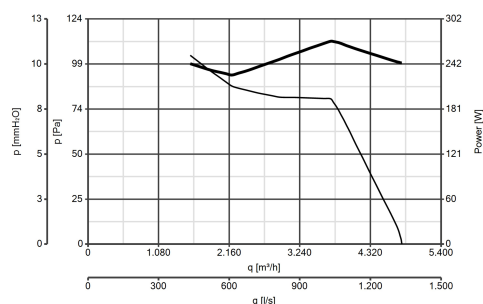

ACCESSORIES



IREM 3 CD 99250080

Code 12931

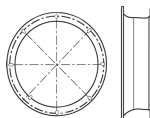

MPC BO 400 (BOCCAGLIO)

Code 22538

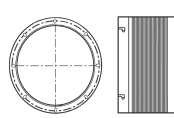

MPC RA 400 (RACCORDO FLESSIBILE)

Code 22519



MPC SU 400 (SUPPORTO)

Code 22534

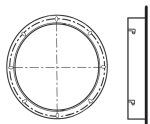

MPC FL 400 (FLANGIA)

Code 22526

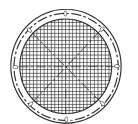

MPC RP 400 (RETE DI PROTEZIONE)

Code 22530



IRM 40

Code 12922

PER INFORMAZIONI:

Servizio al Cliente: tel +39 02 90699395 premendo 1 dopo messaggio registrato (consulenza su prodotti e impianti)

Pre & Post Vendita: fax +39 02 90699302

Email prevendita: prevendita@vortice-italy.com