

Technical Data Sheet

CODE 42263

MPC-E 254 M

Medium-pressure long cased axial fans



Certifications

CE CE

EAC EAC

TECHNICAL AND PERFORMANCE DATA

Absorbed Current max (A)	0,32	Number of Poles	4
Absorbed Power max (W)	70	Voltage (V)	230
Frequency (Hz)	50	Weight (Kg)	8,2
Insulation Class	I°	Delivery max (l/s)	328
IP	X4	Delivery max (m³/h)	1180
Max ambient temperature for continuous operation (°C)	70	Pressure max (mmH2O)	9,0
Min ambient temperature for continuous operation (°C)	-25	Pressure max (Pa)	82
Motor IP protection	55	RPM	1460
Nominal Diameter (mm)	250	Sound power level Lw [dB(A)]	45,8
Number of Phases (Ph)	1	Sound Pressure level Lp [dB (A)] 3m	25,3

DIMENSIONS

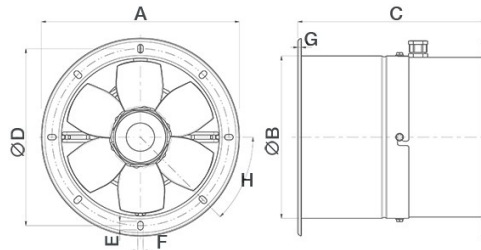

Size A (mm)	∅ 319
Size B (mm)	∅ 264
Size C (mm)	300
Size D (mm)	∅ 292
Size E (mm)	14
Size F (mm)	9
Size G (mm)	4
Size H (mm)	45°

PER INFORMAZIONI:

Servizio al Cliente: tel +39 02 90699395 premendo 1 dopo messaggio registrato (consulenza su prodotti e impianti)

Pre & Post Vendita: fax +39 02 90699302

Email prevendita: prevendita@vortice-italy.com

Technical Data Sheet

CODE 42263

MPC-E 254 M

Medium-pressure long cased axial fans



DESCRIPTION

- Nominal diameter 250 mm
- 2 rolled steel flange sections, welded, phosphated and polyester powder coated in practical grey colour with hammered effect finish, guaranteeing long-term resistance to atmospheric agents.
- 1 speed single phase AC motor with shaft turning in double shielded ball bearings, insulation class F.
- Maximum air flow: 1,180 m³/h.
- Impeller with 6 wing profile blades, dynamically balanced (UNI ISO 1940 – Balancing class 6.3), optimized to deliver maximum performance and low noise levels, moulded from filled polypropylene for superior dimensional stability and resistance to atmospheric agents, and keyed to a diecast aluminium hub.
- Vortice speed controller.

CURVES

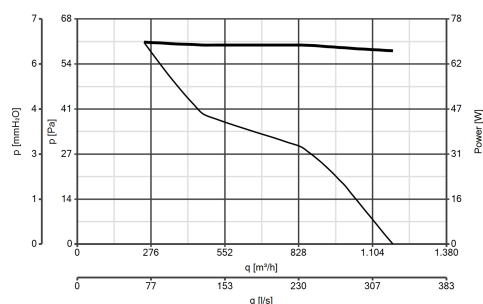

ACCESSORIES



IRM 30
Code 12921



IREM 3 CD
99250080
Code 12931

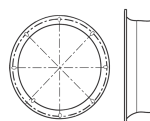

MPC BO 250
(BOCCAGLIO)
Code 22535

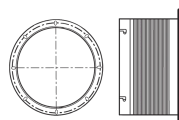

MPC RA 250
(RACCORDO FLESSIBILE)
Code 22516



MPC SU 250
(SUPPORTO)
Code 22531

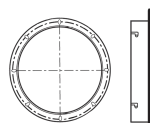

MPC FL 250
(FLANGIA)
Code 22523

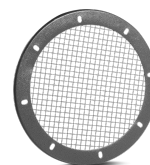

MPC RP 250
(RETE DI PROTEZIONE)
Code 22527

PER INFORMAZIONI:

Servizio al Cliente: tel +39 02 90699395 premendo 1 dopo messaggio registrato (consulenza su prodotti e impianti)

Pre & Post Vendita: fax +39 02 90699302

Email prevendita: prevendita@vortice-italy.com